

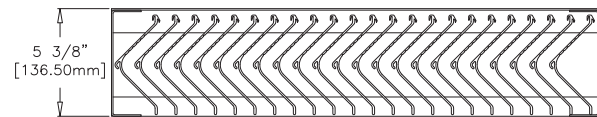

### STORM CLASS™ LOUVER

<b>Visible Mullion Louver Type</b> .....	SCV6
<b>Material</b> .....	Extruded Aluminum (Alloy 6063-T5)
<b>Stationary Blade</b> .....	0.081 in. (2.06 mm)
<b>Frame</b> .....	0.081 in. (2.06 mm)
<b>Louwer Depth</b> .....	5 3/8 in. (136.5 mm)
<b>Free Area – 4 ft. x 4 ft. Unit</b> .....	8.73 sq. ft. (0.81 m <sup>2</sup> )
<b>Percent Free Area</b> .....	54.6%
<b>Free Area Velocity at Beginning Point of Water Penetration – 0.01 oz H<sub>2</sub>O/sq. ft. Free Area</b> . . . . .above 1,250 fpm (6.35 m/s)	
<b>Air Volume Flow Rate at Beginning Point of Water Penetration – 4 ft. x 4 ft. Unit</b> . . . . . 10,912 cfm (5.15 m <sup>3</sup> /s)	
<b>Pressure Drop at Beginning Point of Water Penetration</b> . . . . . 0.20 in. H <sub>2</sub> O (0.040 kPa)	
<b>Wind-Driven Rain Water Penetration Data</b>	
Exterior Wind Velocity. . . . .	29 mph (13 m/s)
Rainfall Rate . . . . .	3 in. (75 mm)/hour
Effectiveness . . . . .	100.0%
Core Ventilation Rate . . . . .	988 fpm (5.0 m/s)
Exterior Wind Velocity. . . . .	50 mph (22 m/s)
Rainfall Rate . . . . .	8 in. (200 mm)/hour
Effectiveness . . . . .	100.0%
Core Ventilation Rate . . . . .	964 fpm (5.0 m/s)

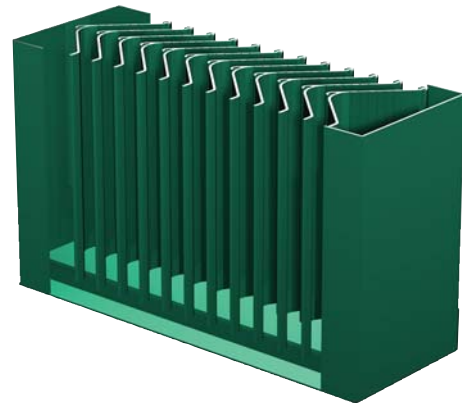

### RECOMMENDED SPECIFICATION

#### GENERAL

Furnish and install where indicated on plans or described in schedules Storm Class™ Louver Type SCV6 as designed and manufactured by The Airlite Company LLC, Schofield, Wisconsin. Louvers shall be furnished with bird screen, insect screen, supports, installation hardware and finishes as specified and as required for a complete installation.

#### SUBMITTALS

Manufacturer shall submit shop drawings incorporating key plans, elevations, sections and details showing profiles, angles and spacing of louver blades and frames; unit dimensions related to wall openings and construction; and, anchorage details and locations. Provide samples of manufacturer's finish and color charts showing the full range of colors available. For each type of product specified, submit free area, air performance, water penetration and wind driven rain ratings determined in accordance with AMCA Standard 500-L 99 and licensed under the AMCA Certified Ratings Program.

#### PRODUCTS

Louvers shall be Storm Class™ type and rated to resist water penetration under wind-driven rain conditions. Louvers shall be 5 3/8-inches (136.5 mm) deep and assembled from extruded aluminum blades and fabricated perimeter. Blades and frames shall be 0.081-inch (2 mm) thick aluminum, alloy 6063-T5. Blades shall be vertical, V-type with a center hook and spaced 1-inch (25.4 mm) on center.

#### ALL-WELDED ASSEMBLY

Join stationary blade and frames and frame members with fillet welds concealed from view, unless the size of the louver makes bolted connections between louver sections necessary. Louver blades shall be joined to each jamb frame with a minimum of two fillet welds produced with the Pulsed Gas Metal Arc Welding (GMAW/Mig) process. Each weld shall be a minimum of 1-inch (25.4 mm) in length with a minimum 1/8-inch (3.175 mm) leg. Frames shall be joined at each corner with a full-length GMAW fillet weld with a minimum 1/8-inch (3.175 mm) throat.

#### STRUCTURAL DESIGN CRITERIA

Manufacturer shall design and furnish all supports required to withstand a wind force of not less than 25 pounds per square foot. Louvers larger than 72-inches (183 cm) wide x 72-inches (183 cm) high will be fabricated and installed in multiple sections. Louver blades, frames, mullions and anchorages shall be demonstrated to withstand the specified wind design load.

#### PERFORMANCE RATINGS

FREE AREA:	8.73 Square Feet (0.81 m <sup>2</sup> )
MINIMUM FREE AREA VELOCITY at Beginning Point of Water Penetration:	1,250 fpm (6.35 m/s)
MINIMUM AIR VOLUME FLOW RATE at Beginning Point of Water Penetration:	10,912 cfm (5.15 m <sup>3</sup> /s)
MAXIMUM STATIC PRESSURE at Beginning Point of Water Penetration:	0.20 in. H <sub>2</sub> O (0.040 kPa)

See page 3 for complete Wind-Driven Rain Performance  
See page 4 for complete finish options

# LOUVER TYPE SCV6 PRODUCT DESCRIPTION & DETAILS

Wind-driven rain is rainfall that is carried by the wind and driven onto the building façade. It is a complex phenomenon of falling raindrops in a turbulent flow of air around a structure. Wind-driven rain is one of the critical factors that ultimately determine the long-term use and effectiveness of building envelopes. In 1999, AMCA Standard 500 was modified to recognize the phenomenon of wind-driven rain with a rigorous new test procedure that measures the effectiveness of louver performance under wind-driven rain conditions. Airolite Storm Class™ louvers are designed and rated to provide high volume intake and exhaust ventilation and restrict water penetration under the most severe wind-driven rain conditions. Airolite Storm Class™ Louver Type SCV6 is a 5 3/8-inch (136.5 mm) deep vertical blade louver rated to be 100% effective at a core area ventilation rate of 964 fpm (5.0 m/s) when tested at a wind velocity of 50 mph (22.42 m/s) and 8-inch (203.2 ml) per hour rainfall rate. Airolite Storm Class™ Louver Type SCV6 is a highly effective louver with AMCA Licensed Air Performance, Water Penetration and Wind-Driven Rain performance ratings that enable designers to select and specify this product with confidence. Please contact your local Airolite representative or the factory for assistance with the layout and design of support systems when required.

## VERTICAL SECTION DETAIL

## PLAN SECTION DETAIL

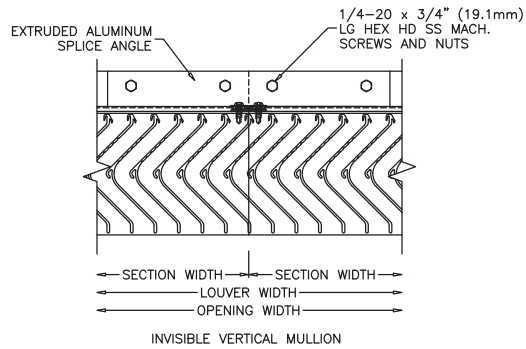
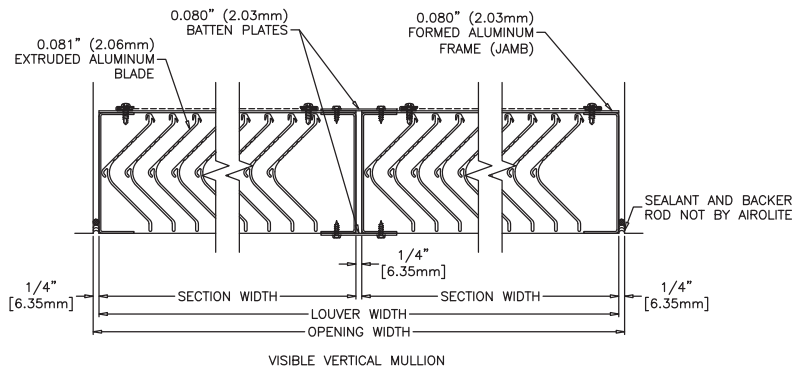
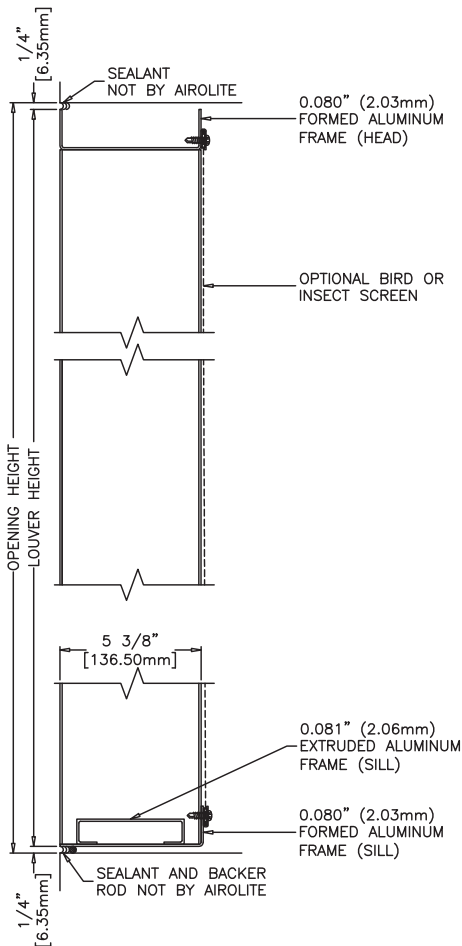

### Minimum Section Size:

12 in. (31 cm) W x 12 in. (31 cm) H

### Maximum Section Size:

72 in. (183 cm) W x 72 in. (183 cm) H

## ACCESSORY ITEM

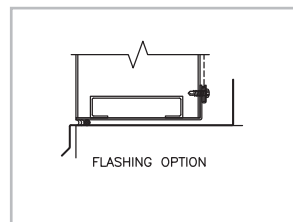

# LOUVER TYPE SCV6 PERFORMANCE RATINGS

## FREE AREA CHART - in square feet

Louver Height Inches	Louver Width in Inches					
	12	24	36	48	60	72
12	0.33	0.77	1.20	1.64	2.08	2.52
24	0.80	1.87	2.94	4.01	5.07	6.14
36	1.27	2.97	4.67	6.37	8.07	9.77
48	1.75	4.08	6.41	8.73	11.06	13.39
60	2.22	5.18	8.14	11.10	14.06	17.02
72	2.69	6.28	9.87	13.46	17.05	20.64



The Airlite Company, LLC certifies that Louver Type SCV6 shown herein is licensed to bear the AMCA seal. The ratings shown are based on tests and procedures performed in accordance with AMCA Publication 511 and comply with the requirements of the AMCA Certified Ratings Program. The AMCA Certified Ratings Seal applies to Water Penetration, Air Performance and Wind Driven Rain.

## WATER PENETRATION

(Standard Air - .075 lb./ft.<sup>3</sup>; Test Size - 48 in x 48 in.; Test Duration - 15 min.)

The AMCA Water Penetration Test provides a method for comparing various louver models and designs as to their efficiency in resisting the penetration of rainfall under specific laboratory test conditions. The beginning point of water penetration is defined as that velocity where the water penetration curve projects through 0.01 oz. of water (penetration) per sq. ft. of louver free area. These performance ratings do not guarantee a louver to be weather-proof or stormproof and should be used in combination with other factors including good engineering judgement in selecting louvers. **\*The beginning point of water penetration for Model SCV6 is above 1,250 fpm (6.35 m/s) free area velocity.**

## WIND-DRIVEN RAIN PERFORMANCE

75mm/h (3 in/hr) Rainfall & 13 m/s (29 mph) Wind Velocity				200mm/h (8 in/hr) Rainfall & 22 m/s (50 mph) Wind Velocity			
Free Area Ventilation Rate (fpm)	Ventilation Air Core Velocity m/s (fpm)	Water Penetration Effect. %	Water Penetration Classification	Free Area Ventilation Rate (fpm)	Ventilation Air Core Velocity m/s (fpm)	Water Penetration Effect. %	Water Penetration Classification
0	0 (0)			0	0 (0)		
161	98 (0.5)			161	98 (0.5)		
324	197 (1.0)			324	197 (1.0)		
485	295 (1.5)			485	295 (1.5)		
647	394 (2.0)			647	394 (2.0)		
808	492 (2.5)			808	492 (2.5)		
971	591 (3.0)			971	591 (3.0)		
1132	689 (3.5)			1132	689 (3.5)		
1293	787 (4.0)			1293	787 (4.0)		
1455	886 (4.5)			1455	886 (4.5)		
1623	988 (5.0)	100.0	A	1584	964 (5.0)	100.0	A

Discharge Loss Coefficient Class (Intake) = 2

Weather louvers shall be classified by their ability to reject simulated rain. The table below shows different classifications based on the maximum simulated rain penetration per square meter (square feet) of louver. Water penetration rating at a given louver face velocity is determined by the water penetration while the louver is subjected to a selected simulated rainfall rate and wind velocity.

Discharge Loss Coefficient Classifications	
Class	Discharge Loss Coefficient
1	0.4 and Above
2	0.3 to 0.399
3	0.2 to 0.299
4	0.199 and Below

Wind Driven Rain Penetration Classes	
Class	Effectiveness
A	1 to 0.99
B	0.989 to 0.95
C	0.949 to 0.80
D	Below 0.80

## AIRFLOW RESISTANCE

(Standard Air - .075 lb./ft.<sup>3</sup>)

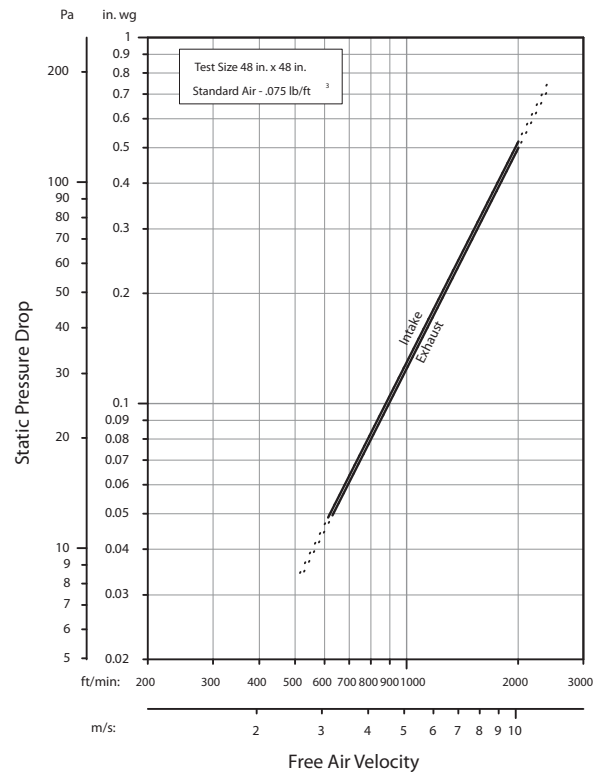

Louver Type SCV6 resistance to airflow varies depending on louver application (air intake or air exhaust). Free area velocities (shown) are higher than the average velocity through the overall louver size.

# LOUVER TYPE SCV6 METHOD OF INSTALLATION & ACCESSORY OPTIONS

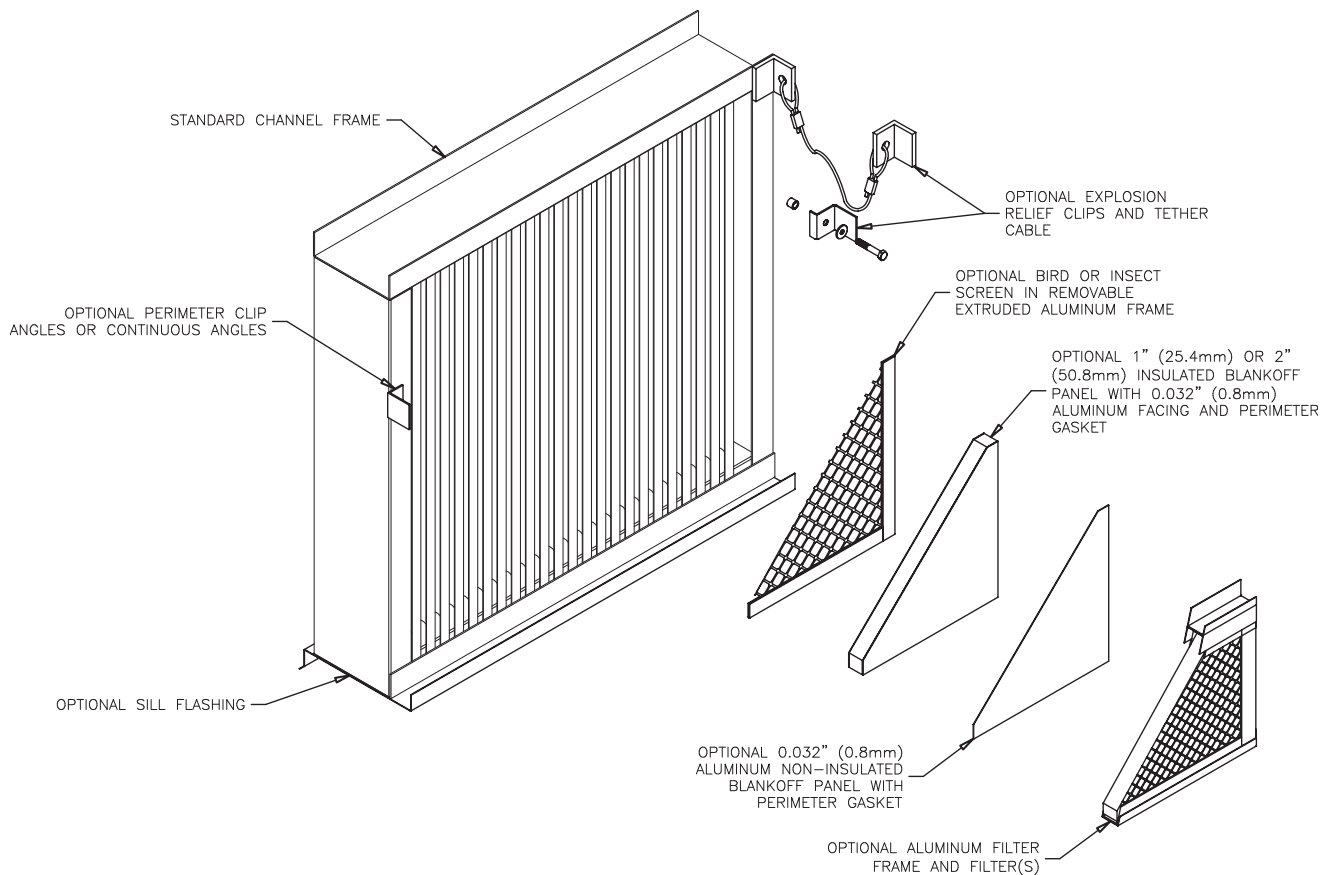

## FINISHES (Select one of the following)

**ACRYLIC ENAMEL:** Louvers shall be cleaned, pretreated and Finished with an oven-cured thermosetting acrylic enamel finish that meets or exceeds the performance requirements of AAMA 2603, "Voluntary Specification Performance Requirements and Test Procedures for Pigmented Organic Coatings."

**2-COAT FLUOROPOLYMER:** Louvers shall be cleaned, pretreated and Finished with an inhibitive primer and oven-cured Kynar 500® / Hylar 5000® resin coating with minimum 1.2 mils dry-film coating thickness that meets or exceeds the performance requirements of AAMA 2605, "Voluntary Specification, Performance Requirements and Test Procedures for Superior Performance Organic Coatings on Aluminum Extrusions and Panels."

**3-COAT FLUOROPOLYMER:** Louvers shall be cleaned, pretreated and Finished with an inhibitive primer and oven-cured Kynar 500® / Hylar 5000® resin coating with minimum 2.0 mils dry-film coating thickness that meets or exceeds the performance requirements of AAMA 2605, "Voluntary Specification, Performance Requirements and Test Procedures for Superior Performance Organic Coatings on Aluminum Extrusions and Panels."

**CLEAR ANODIZE:** Louvers shall be Finished with a Class I clear anodized coating (AA-M10C22A41) that complies with the performance requirements of AAMA Specification 611-98, "Voluntary Specification for Anodized Architectural Aluminum."

**COLOR ANODIZE:** Louvers shall be Finished with a Class I electrolytically color anodized coating (AA-M10C22A42/44) that complies with the performance requirements of AAMA Specification 611-98, "Voluntary Specification for Anodized Architectural Aluminum." Color shall be (select one): Champagne, Light Bronze, Medium Bronze, Dark Bronze, Extra Dark Bronze or Black Anodize.



P.O. Box 410, 525 Western Road, Schofield, WI 54476-0410 USA  
715.841.8757 • fax 715.841.8773 • www.airolite.com

Submission SCV6 June 2010  
Copyright ©2010 The Airlite Company, LLC

The Airlite Company, LLC reserves the right to make product changes.

**THE ALL-WELDED ADVANTAGE** 